



# Stealth Cushion Order Form

104 John Kelly Drive, Burnet, TX 78611 | Phone: 800-965-9229 | Fax: 800-806-1225 | Email: info@stealthproducts.com

Account Number: \_\_\_\_\_ Date: \_\_\_\_\_ PO Number: \_\_\_\_\_  
 Provider Name: \_\_\_\_\_ Marked for: \_\_\_\_\_  
 Contact: \_\_\_\_\_ Ship to Address: \_\_\_\_\_  
 Phone: \_\_\_\_\_ Fax: \_\_\_\_\_ City: \_\_\_\_\_ State: \_\_\_\_\_ Zip: \_\_\_\_\_  
 Email: \_\_\_\_\_

This form is interactive when viewed with [Adobe Acrobat Reader](#) and may not function correctly if opened with applications other than Acrobat. HCPCS codes provided should not be considered as legal advice and do not guarantee reimbursement. DME providers are responsible for determining appropriate billing codes when submitting for insurance reimbursement. All prices are on-chair MSRP. Prices, specifications, part numbers, and availability are subject to change without notice.

## 1. CUSHION CONFIGURATION

This section allows a quick selection of a single cushion. The XYYY portion of the part number directly relates to the dimensions of the cushion, where XX represents the width and YY represents the depth. Specific cushion/component sizes available and part numbers can be found in the specific cushion sections on the subsequent pages. Complete the custom cushion section for sizes not shown in the specific cushion section.

### 1. Cushion Dimensions

|                             |       |       |       |       |       |                             |       |       |       |       |       |
|-----------------------------|-------|-------|-------|-------|-------|-----------------------------|-------|-------|-------|-------|-------|
| <b>Cushion Width:</b> _____ |       |       |       |       |       | <b>Cushion Depth:</b> _____ |       |       |       |       |       |
| 14" W                       | 17" W | 19" W | 22" W | 26" W | 30" W | 14" D                       | 17" D | 19" D | 22" D | 26" D | 30" D |
| 16" W                       | 18" W | 20" W | 24" W | 28" W | 32" W | 16" D                       | 18" D | 20" D | 24" D | 28" D | 32" D |

### 2. Cushion Model Selection

#### SIMPLICITY G CUSHION

General use with 2-way stretch, breathable cover.

Part series: ST-SIMGXYYY (See page 2)

|                      |       |
|----------------------|-------|
| E2601, 16"W to 20" W | \$110 |
| E2602, 22"W to 24" W | \$165 |

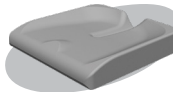

#### SOLUTION SPP CUSHION

Skin protection and positioning with 4-way stretch, breathable cover. Includes urethane liner.

Part series: ST-SOLSPPXYYY (See page 3)

|                      |       |
|----------------------|-------|
| E2607, 14"W to 20" W | \$375 |
| E2608, 22"W to 24" W | \$430 |

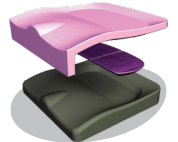

#### TRU-COMFORT 2 SPP CUSHION

Skin protection and positioning with 4-way stretch, breathable cover.

Part series: ST-TC2SPPXYYY (see page 2)

|                      |       |
|----------------------|-------|
| E2607, 16"W to 20" W | \$400 |
| E2608, 22"W          | \$500 |



#### SPECTRUM GEL SPP CUSHION

Positioning with 4-way stretch, breathable cover. Includes urethane liner.

Part series: ST-SPCGSPPXYYY (see page 2)

|                      |       |
|----------------------|-------|
| E2607, 14"W to 20" W | \$460 |
| E2608, 22"W to 24" W | \$530 |

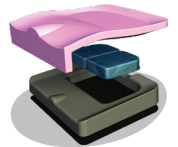

#### SPECTRUM FOAM SPP CUSHION

Skin protection and positioning with 4-way stretch, breathable cover.

Part series: ST-SPCFSPXYYY (see page 2)

|                      |       |
|----------------------|-------|
| E2607, 16"W to 20" W | \$460 |
| E2608, 22"W to 24" W | \$530 |
| E2608, 26"W to 32" W | \$590 |

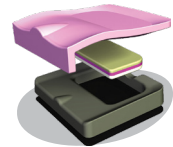

### 3. Additional Fluid Proof Liners

Fluid Proof Urethane Liner ..... \$50-\$70  
Part: URL1709070-XXYY, see page 3.  
Not available with Simplicity and TRU-Comfort 2.

Fluid Proof Polyurethane Liner ..... Coming soon  
Not available with Simplicity.

#### Liner Installation

Install Liner on Cushion

### 4. Add Solid Base

ABS Flat Rigidizer ..... \$45-\$65  
Part: See subsequent parts list, see page 4.  
Not available with TRU-Comfort 2 cushion.

ACM Rigidizer ..... \$95  
Part: See subsequent parts list, see page 4.  
For use with manual wheelchair only.

**2. SIMPLICITY G CUSHION**

| Size        | Part        | HCPCS | MSRP  | Size        | Part        | HCPCS | MSRP  |
|-------------|-------------|-------|-------|-------------|-------------|-------|-------|
| 16"W x 16"D | ST-SIMG1616 | E2601 | \$110 | 20"W x 18"D | ST-SIMG2018 | E2601 | \$110 |
| 16"W x 18"D | ST-SIMG1618 | E2601 | \$110 | 20"W x 20"D | ST-SIMG2020 | E2601 | \$110 |
| 18"W x 16"D | ST-SIMG1816 | E2601 | \$110 | 22"W x 18"D | ST-SIMG2218 | E2602 | \$165 |
| 18"W x 18"D | ST-SIMG1818 | E2601 | \$110 | 22"W x 20"D | ST-SIMG2220 | E2602 | \$165 |
| 18"W x 20"D | ST-SIMG1820 | E2601 | \$110 | 24"W x 18"D | ST-SIMG2418 | E2602 | \$165 |
| 20"W x 16"D | ST-SIMG2016 | E2601 | \$110 |             |             |       |       |

**3. TRU-COMFORT 2 SPP CUSHION**

| Size        | Part          | HCPCS | MSRP  | Size        | Part          | HCPCS | MSRP  |
|-------------|---------------|-------|-------|-------------|---------------|-------|-------|
| 16"W x 14"D | ST-TC2SPP1614 | E2607 | \$400 | 20"W x 18"D | ST-TC2SPP2018 | E2607 | \$400 |
| 16"W x 16"D | ST-TC2SPP1616 | E2607 | \$400 | 20"W x 20"D | ST-TC2SPP2020 | E2607 | \$400 |
| 16"W x 18"D | ST-TC2SPP1618 | E2607 | \$400 | 20"W x 22"D | ST-TC2SPP2022 | E2607 | \$400 |
| 16"W x 20"D | ST-TC2SPP1620 | E2607 | \$400 | 20"W x 24"D | ST-TC2SPP2024 | E2607 | \$400 |
| 18"W x 16"D | ST-TC2SPP1816 | E2607 | \$400 | 22"W x 18"D | ST-TC2SPP2218 | E2608 | \$500 |
| 18"W x 18"D | ST-TC2SPP1818 | E2607 | \$400 | 22"W x 20"D | ST-TC2SPP2220 | E2608 | \$500 |
| 18"W x 20"D | ST-TC2SPP1820 | E2607 | \$400 | 22"W x 22"D | ST-TC2SPP2222 | E2608 | \$500 |
| 18"W x 22"D | ST-TC2SPP1822 | E2607 | \$400 | 22"W x 24"D | ST-TC2SPP2224 | E2608 | \$500 |
| 20"W x 16"D | ST-TC2SPP2016 | E2607 | \$400 |             |               |       |       |

**4. SPECTRUM GEL SPP CUSHION**

| Size        | Part           | HCPCS | MSRP  | Size        | Part           | HCPCS | MSRP  |
|-------------|----------------|-------|-------|-------------|----------------|-------|-------|
| 14"W x 18"D | ST-SPCGSPP1418 | E2607 | \$460 | 19"W x 20"D | ST-SPCGSPP1920 | E2607 | \$460 |
| 16"W x 16"D | ST-SPCGSPP1616 | E2607 | \$460 | 20"W x 16"D | ST-SPCGSPP2016 | E2607 | \$460 |
| 16"W x 18"D | ST-SPCGSPP1618 | E2607 | \$460 | 20"W x 18"D | ST-SPCGSPP2018 | E2607 | \$460 |
| 16"W x 19"D | ST-SPCGSPP1619 | E2607 | \$460 | 20"W x 19"D | ST-SPCGSPP2019 | E2607 | \$460 |
| 16"W x 20"D | ST-SPCGSPP1620 | E2607 | \$460 | 20"W x 20"D | ST-SPCGSPP2020 | E2607 | \$460 |
| 17"W x 16"D | ST-SPCGSPP1716 | E2607 | \$460 | 20"W x 22"D | ST-SPCGSPP2022 | E2607 | \$460 |
| 17"W x 17"D | ST-SPCGSPP1717 | E2607 | \$460 | 20"W x 24"D | ST-SPCGSPP2024 | E2607 | \$460 |
| 17"W x 18"D | ST-SPCGSPP1718 | E2607 | \$460 | 22"W x 16"D | ST-SPCGSPP2216 | E2608 | \$530 |
| 17"W x 19"D | ST-SPCGSPP1719 | E2607 | \$460 | 22"W x 18"D | ST-SPCGSPP2218 | E2608 | \$530 |
| 17"W x 20"D | ST-SPCGSPP1720 | E2607 | \$460 | 22"W x 19"D | ST-SPCGSPP2219 | E2608 | \$530 |
| 18"W x 16"D | ST-SPCGSPP1816 | E2607 | \$460 | 22"W x 20"D | ST-SPCGSPP2220 | E2608 | \$530 |
| 18"W x 17"D | ST-SPCGSPP1817 | E2607 | \$460 | 22"W x 22"D | ST-SPCGSPP2222 | E2608 | \$530 |
| 18"W x 18"D | ST-SPCGSPP1818 | E2607 | \$460 | 22"W x 24"D | ST-SPCGSPP2224 | E2608 | \$530 |
| 18"W x 20"D | ST-SPCGSPP1820 | E2607 | \$460 | 24"W x 16"D | ST-SPCGSPP2416 | E2608 | \$530 |
| 18"W x 22"D | ST-SPCGSPP1822 | E2607 | \$460 | 24"W x 18"D | ST-SPCGSPP2418 | E2608 | \$530 |
| 18"W x 24"D | ST-SPCGSPP1824 | E2607 | \$460 | 24"W x 20"D | ST-SPCGSPP2420 | E2608 | \$530 |
| 19"W x 17"D | ST-SPCGSPP1917 | E2607 | \$460 | 24"W x 22"D | ST-SPCGSPP2422 | E2608 | \$530 |
| 19"W x 18"D | ST-SPCGSPP1918 | E2607 | \$460 | 24"W x 24"D | ST-SPCGSPP2424 | E2608 | \$530 |
| 19"W x 19"D | ST-SPCGSPP1919 | E2607 | \$460 |             |                |       |       |

**5. SPECTRUM FOAM SPP CUSHION**

| Size        | Part          | HCPCS | MSRP  | Size        | Part          | HCPCS | MSRP  |
|-------------|---------------|-------|-------|-------------|---------------|-------|-------|
| 16"W x 16"D | ST-SPCFSP1616 | E2607 | \$460 | 24"W x 16"D | ST-SPCFSP2416 | E2608 | \$530 |
| 16"W x 18"D | ST-SPCFSP1618 | E2607 | \$460 | 24"W x 18"D | ST-SPCFSP2418 | E2608 | \$530 |
| 16"W x 20"D | ST-SPCFSP1620 | E2607 | \$460 | 24"W x 20"D | ST-SPCFSP2420 | E2608 | \$530 |
| 17"W x 17"D | ST-SPCFSP1717 | E2607 | \$460 | 24"W x 22"D | ST-SPCFSP2422 | E2608 | \$530 |
| 17"W x 18"D | ST-SPCFSP1718 | E2607 | \$460 | 24"W x 24"D | ST-SPCFSP2424 | E2608 | \$530 |
| 17"W x 19"D | ST-SPCFSP1719 | E2607 | \$460 | 26"W x 18"D | ST-SPCFSP2618 | E2608 | \$590 |
| 18"W x 16"D | ST-SPCFSP1816 | E2607 | \$460 | 26"W x 20"D | ST-SPCFSP2620 | E2608 | \$590 |
| 18"W x 18"D | ST-SPCFSP1818 | E2607 | \$460 | 26"W x 22"D | ST-SPCFSP2622 | E2608 | \$590 |
| 18"W x 20"D | ST-SPCFSP1820 | E2607 | \$460 | 26"W x 24"D | ST-SPCFSP2624 | E2608 | \$590 |
| 18"W x 22"D | ST-SPCFSP1822 | E2607 | \$460 | 28"W x 18"D | ST-SPCFSP2818 | E2608 | \$590 |
| 19"W x 17"D | ST-SPCFSP1917 | E2607 | \$460 | 28"W x 20"D | ST-SPCFSP2820 | E2608 | \$590 |
| 19"W x 19"D | ST-SPCFSP1919 | E2607 | \$460 | 28"W x 22"D | ST-SPCFSP2822 | E2608 | \$590 |
| 20"W x 16"D | ST-SPCFSP2016 | E2607 | \$460 | 28"W x 24"D | ST-SPCFSP2824 | E2608 | \$590 |
| 20"W x 18"D | ST-SPCFSP2018 | E2607 | \$460 | 28"W x 28"D | ST-SPCFSP2828 | E2608 | \$590 |
| 20"W x 20"D | ST-SPCFSP2020 | E2607 | \$460 | 30"W x 18"D | ST-SPCFSP3018 | E2608 | \$590 |
| 20"W x 22"D | ST-SPCFSP2022 | E2607 | \$460 | 30"W x 20"D | ST-SPCFSP3020 | E2608 | \$590 |
| 20"W x 24"D | ST-SPCFSP2024 | E2607 | \$460 | 30"W x 22"D | ST-SPCFSP3022 | E2608 | \$590 |
| 22"W x 18"D | ST-SPCFSP2218 | E2608 | \$530 | 30"W x 24"D | ST-SPCFSP3024 | E2608 | \$590 |
| 22"W x 20"D | ST-SPCFSP2220 | E2608 | \$530 | 30"W x 28"D | ST-SPCFSP3028 | E2608 | \$590 |
| 22"W x 22"D | ST-SPCFSP2222 | E2608 | \$530 | 32"W x 26"D | ST-SPCFSP3226 | E2608 | \$590 |
| 22"W x 24"D | ST-SPCFSP2224 | E2608 | \$530 | 32"W x 28"D | ST-SPCFSP3228 | E2608 | \$590 |

**6. SOLUTION SPP CUSHION**

| Size        | Part          | HCPCS | MSRP  | Size        | Part          | HCPCS | MSRP  |
|-------------|---------------|-------|-------|-------------|---------------|-------|-------|
| 14"W x 14"D | ST-SOLSPP1414 | E2607 | \$375 | 18"W x 20"D | ST-SOLSPP1820 | E2607 | \$375 |
| 14"W x 16"D | ST-SOLSPP1416 | E2607 | \$375 | 18"W x 22"D | ST-SOLSPP1822 | E2607 | \$375 |
| 14"W x 18"D | ST-SOLSPP1418 | E2607 | \$375 | 19"W x 18"D | ST-SOLSPP1918 | E2607 | \$375 |
| 16"W x 16"D | ST-SOLSPP1616 | E2607 | \$375 | 19"W x 19"D | ST-SOLSPP1919 | E2607 | \$375 |
| 16"W x 17"D | ST-SOLSPP1617 | E2607 | \$375 | 19"W x 20"D | ST-SOLSPP1920 | E2607 | \$375 |
| 16"W x 18"D | ST-SOLSPP1618 | E2607 | \$375 | 20"W x 16"D | ST-SOLSPP2016 | E2607 | \$375 |
| 16"W x 19"D | ST-SOLSPP1619 | E2607 | \$375 | 20"W x 18"D | ST-SOLSPP2018 | E2607 | \$375 |
| 16"W x 20"D | ST-SOLSPP1620 | E2607 | \$375 | 20"W x 19"D | ST-SOLSPP2019 | E2607 | \$375 |
| 17"W x 16"D | ST-SOLSPP1716 | E2607 | \$375 | 20"W x 20"D | ST-SOLSPP2020 | E2607 | \$375 |
| 17"W x 17"D | ST-SOLSPP1717 | E2607 | \$375 | 20"W x 22"D | ST-SOLSPP2022 | E2607 | \$375 |
| 17"W x 18"D | ST-SOLSPP1718 | E2607 | \$375 | 22"W x 18"D | ST-SOLSPP2218 | E2608 | \$430 |
| 17"W x 19"D | ST-SOLSPP1719 | E2607 | \$375 | 22"W x 20"D | ST-SOLSPP2220 | E2608 | \$430 |
| 17"W x 20"D | ST-SOLSPP1720 | E2607 | \$375 | 22"W x 22"D | ST-SOLSPP2222 | E2608 | \$430 |
| 18"W x 16"D | ST-SOLSPP1816 | E2607 | \$375 | 24"W x 20"D | ST-SOLSPP2420 | E2608 | \$430 |
| 18"W x 18"D | ST-SOLSPP1818 | E2607 | \$375 | 24"W x 22"D | ST-SOLSPP2422 | E2608 | \$430 |
| 18"W x 19"D | ST-SOLSPP1819 | E2607 | \$375 |             |               |       |       |

**7. URETHANE CUSHION LINERS - SPECTRUM, SOLUTION**

| Size        | Part            | MSRP | Size        | Part            | MSRP |
|-------------|-----------------|------|-------------|-----------------|------|
| 14"W x 14"D | URL1709070-1414 | \$50 | 20"W x 24"D | URL1709070-2024 | \$60 |
| 14"W x 16"D | URL1709070-1416 | \$50 | 22"W x 16"D | URL1709070-2216 | \$60 |
| 14"W x 18"D | URL1709070-1418 | \$50 | 22"W x 18"D | URL1709070-2218 | \$60 |
| 16"W x 16"D | URL1709070-1616 | \$50 | 22"W x 19"D | URL1709070-2219 | \$60 |
| 16"W x 18"D | URL1709070-1618 | \$50 | 22"W x 20"D | URL1709070-2220 | \$60 |
| 16"W x 19"D | URL1709070-1619 | \$50 | 22"W x 22"D | URL1709070-2222 | \$60 |
| 16"W x 20"D | URL1709070-1620 | \$50 | 22"W x 24"D | URL1709070-2224 | \$60 |
| 17"W x 16"D | URL1709070-1716 | \$50 | 24"W x 16"D | URL1709070-2416 | \$60 |
| 17"W x 17"D | URL1709070-1717 | \$50 | 24"W x 18"D | URL1709070-2418 | \$60 |
| 17"W x 18"D | URL1709070-1718 | \$50 | 24"W x 20"D | URL1709070-2420 | \$60 |
| 17"W x 19"D | URL1709070-1719 | \$50 | 24"W x 22"D | URL1709070-2422 | \$60 |
| 17"W x 20"D | URL1709070-1720 | \$50 | 24"W x 24"D | URL1709070-2424 | \$60 |
| 18"W x 16"D | URL1709070-1816 | \$50 | 26"W x 18"D | URL1709070-2618 | \$70 |
| 18"W x 17"D | URL1709070-1817 | \$50 | 26"W x 20"D | URL1709070-2620 | \$70 |
| 18"W x 18"D | URL1709070-1818 | \$50 | 26"W x 22"D | URL1709070-2622 | \$70 |
| 18"W x 19"D | URL1709070-1819 | \$50 | 26"W x 24"D | URL1709070-2624 | \$70 |
| 18"W x 20"D | URL1709070-1820 | \$50 | 28"W x 18"D | URL1709070-2818 | \$70 |
| 18"W x 22"D | URL1709070-1822 | \$50 | 28"W x 20"D | URL1709070-2820 | \$70 |
| 18"W x 24"D | URL1709070-1824 | \$50 | 28"W x 22"D | URL1709070-2822 | \$70 |
| 19"W x 17"D | URL1709070-1917 | \$50 | 28"W x 24"D | URL1709070-2824 | \$70 |
| 19"W x 18"D | URL1709070-1918 | \$50 | 28"W x 28"D | URL1709070-2828 | \$70 |
| 19"W x 19"D | URL1709070-1919 | \$50 | 30"W x 18"D | URL1709070-3018 | \$70 |
| 19"W x 20"D | URL1709070-1920 | \$50 | 30"W x 20"D | URL1709070-3020 | \$70 |
| 20"W x 16"D | URL1709070-2016 | \$50 | 30"W x 22"D | URL1709070-3022 | \$70 |
| 20"W x 18"D | URL1709070-2018 | \$50 | 30"W x 24"D | URL1709070-3024 | \$70 |
| 20"W x 19"D | URL1709070-2019 | \$50 | 30"W x 28"D | URL1709070-3028 | \$70 |
| 20"W x 20"D | URL1709070-2020 | \$50 | 32"W x 26"D | URL1709070-3226 | \$70 |
| 20"W x 22"D | URL1709070-2022 | \$60 | 32"W x 28"D | URL1709070-3228 | \$70 |

**8. ABS FLAT RIGIDIZER**

| Compatible Cushion Size | Part         | MSRP | Compatible Cushion Size | Part         | MSRP |
|-------------------------|--------------|------|-------------------------|--------------|------|
| 10"W x 10"D             | DWR1010E187A | \$45 | 22"W x 24"D             | DWR1010E1930 | \$55 |
| 10"W x 12"D             | DWR1010E187C | \$45 | 24"W x 16"D             | DWR1010E194G | \$55 |
| 12"W x 10"D             | DWR1010E188A | \$45 | 24"W x 18"D             | DWR1010E194I | \$55 |
| 12"W x 12"D             | DWR1010E188C | \$45 | 24"W x 20"D             | DWR1010E194K | \$55 |
| 12"W x 14"D             | DWR1010E188E | \$45 | 24"W x 22"D             | DWR1010E194M | \$55 |
| 14"W x 12"D             | DWR1010E189C | \$45 | 24"W x 24"D             | DWR1010E194O | \$55 |
| 14"W x 14"D             | DWR1010E189E | \$45 | 26"W x 18"D             | DWR1010E236I | \$65 |
| 14"W x 16"D             | DWR1010E189G | \$45 | 26"W x 20"D             | DWR1010E236K | \$65 |
| 14"W x 18"D             | DWR1010E189I | \$45 | 26"W x 22"D             | DWR1010E236M | \$65 |
| 16"W x 16"D             | DWR1010E190G | \$45 | 26"W x 24"D             | DWR1010E236O | \$65 |
| 16"W x 18"D             | DWR1010E190I | \$45 | 26"W x 26"D             | DWR1010E236Q | \$65 |
| 16"W x 20"D             | DWR1010E190K | \$45 | 26"W x 28"D             | DWR1010E236S | \$65 |
| 17"W x 17"D             | DWR1010E232H | \$45 | 28"W x 18"D             | DWR1010E245I | \$65 |
| 17"W x 19"D             | DWR1010E232J | \$45 | 28"W x 20"D             | DWR1010E245K | \$65 |
| 18"W x 16"D             | DWR1010E191G | \$45 | 28"W x 22"D             | DWR1010E245M | \$65 |
| 18"W x 18"D             | DWR1010E191I | \$45 | 28"W x 24"D             | DWR1010E245O | \$65 |
| 18"W x 20"D             | DWR1010E191K | \$45 | 28"W x 26"D             | DWR1010E245Q | \$65 |
| 18"W x 22"D             | DWR1010E191M | \$45 | 28"W x 28"D             | DWR1010E245S | \$65 |
| 18"W x 24"D             | DWR1010E191O | \$45 | 30"W x 18"D             | DWR1010E244I | \$65 |
| 19"W x 17"D             | DWR1010E234H | \$45 | 30"W x 20"D             | DWR1010E244K | \$65 |
| 19"W x 19"D             | DWR1010E234J | \$45 | 30"W x 22"D             | DWR1010E244M | \$65 |
| 20"W x 16"D             | DWR1010E192G | \$55 | 30"W x 24"D             | DWR1010E244O | \$65 |
| 20"W x 18"D             | DWR1010E192I | \$55 | 30"W x 26"D             | DWR1010E244Q | \$65 |
| 20"W x 20"D             | DWR1010E192K | \$55 | 30"W x 28"D             | DWR1010E244S | \$65 |
| 20"W x 22"D             | DWR1010E192M | \$55 | 32"W x 18"D             | DWR1010E241I | \$65 |
| 20"W x 24"D             | DWR1010E192O | \$55 | 32"W x 20"D             | DWR1010E241K | \$65 |
| 22"W x 16"D             | DWR1010E193G | \$55 | 32"W x 22"D             | DWR1010E241M | \$65 |
| 22"W x 18"D             | DWR1010E193I | \$55 | 32"W x 24"D             | DWR1010E241O | \$65 |
| 22"W x 20"D             | DWR1010E193K | \$55 | 32"W x 26"D             | DWR1010E241Q | \$65 |
| 22"W x 22"D             | DWR1010E193M | \$55 | 32"W x 28"D             | DWR1010E241S | \$65 |

**9. ACM RIGIDIZER**

| Compatible Cushion Size | Part      | MSRP | Compatible Cushion Size | Part      | MSRP |
|-------------------------|-----------|------|-------------------------|-----------|------|
| 16"W x 16"D             | CUS142467 | \$95 | 18"W x 19"D             | CUS142466 | \$95 |
| 16"W x 17"D             | CUS142467 | \$95 | 18"W x 20"D             | CUS142466 | \$95 |
| 16"W x 18"D             | CUS142467 | \$95 | 20"W x 18"D             | CUS142465 | \$95 |
| 18"W x 16"D             | CUS142466 | \$95 | 20"W x 19"D             | CUS142465 | \$95 |
| 18"W x 18"D             | CUS142466 | \$95 | 20"W x 20"D             | CUS142465 | \$95 |

**10. SPECIAL ORDER CUSHION CONFIGURATION**

Please detail your special order cushion request. All special order cushion requests must be approved with the Stealth Products CSR. Please contact Stealth Products with questions. Extended lead time will apply. Cushion part numbers involved will be the cushion part number listed in previous sections modified to meet special order request stated in details below. Drawings are available below for sketch details.

**1. Special Order Cushion Selection**

- |  |  |
|--|--|
| Special Order Simplicity G..... E2601/E2602 .....\$210-\$265       | Special Order Spectrum Gel SPP ..... E2607/E2608 .....\$610-\$670  |
| Special Order TRU-Comfort 2 SPP ..... E2607/E2608 .....\$550-\$610 | Special Order Spectrum Foam SPP ..... E2607/E2608 .....\$610-\$740 |
| Special Order Solution SPP ..... E2607/E2608 .....\$525-\$585      |  |

Details

---



---



---



---

**2. Special Order Liner Selection**

- Custom Liner .....\$225-\$350

Details

---



---

**3. Special Order Cushion Sketches**

|   |   |
|---|---|
| <p><b>SIMPLICITY G CUSHION</b></p> <p>Top View</p> <p>Front View</p> <p>Right Side View</p>     | <p><b>SOLUTION SPP CUSHION</b></p> <p>Top View</p> <p>Front View</p> <p>Right Side View</p>     |
| <p><b>TRU-COMFORT 2 SPP CUSHION</b></p> <p>Top View</p> <p>Rear View</p> <p>Right Side View</p> | <p><b>SPECTRUM GEL SPP CUSHION</b></p> <p>Top View</p> <p>Front View</p> <p>Right Side View</p> |