

BUZZ
AROUND
Carry On[®]

&

BUZZ
AROUND
Carry On[®]
HD



**Owner's Manual
GB120 & GB220**



Golden Technologies - 401 Bridge Street - Old Forge, PA 18518
Tel: 800-624-6374 - Fax: 800-628-5165 - www.goldentech.com

LIT-GB120-GB220-OM, Rev. D

Thank you for purchasing your Buzzaround Carry On. We are honored you have chosen Golden for your mobility needs.

Standard Packing List:

- | | |
|----------------------|--------------------|
| Owner's Manual | Bottle Holder |
| 12.5 Ah Battery Pack | Cane Holder |
| 6.5 Ah Battery Pack | Red shroud Kit |
| Front Basket | Blue shroud kit |
| Seat with Armrest | Battery Charger |
| Safety Flag | Battery Travel Bag |
| 2 Keys | |

FOR YOUR RECORDS

Please fill in your Buzzaround Carry On information below. This information will be useful in the event that you ever need to contact Golden concerning your scooter.

Your Buzzaround Carry On

Model _____ Serial Number _____

Date of Purchase _____ Body Color _____

Options _____

Your Golden representative or provider

Name _____

Company _____

Address _____

Please remember to fill in and return your warranty registration card.



DISCLAIMER

We ask that you read this manual completely before operating your new Buzzaround Carry On. Golden is not and cannot be held responsible for any damage or injury incurred due to improper or unsafe use of the Golden Buzzaround Carry On . Golden specifically disclaims responsibility for any bodily injury or property damage that may occur during any use that does not comply with applicable federal, state, or local laws or ordinances.

Literature is current at the time of printing. Golden reserves the right to make changes to the product or literature at any time.

Intended Use:

The intended use of this device is to provide mobility to persons limited to a seated position that are capable of operating an electric scooter.

I.	Introduction.....	4
II.	Safety.....	5
III.	EMI / RFI / FCC.....	10
IV.	Specifications.....	12
V.	Main Components.....	13
VI.	Assembly.....	14
VII.	Operation.....	17
VIII.	Fault Diagnosis & Troubleshooting.....	21
IX.	Care & Maintenance.....	22

I. Introduction



Congratulations on the purchase of your new Buzzaround Carry On . The Buzzaround Carry On, combines cutting edge technology with attractive designs that are also highly functional in today's world. We at Golden know that you have chosen a scooter that will give you years of dependable operation and also will enhance the quality of your life by providing you with the mobility to experience an active daily lifestyle.

Even though your new Buzzaround Carry On is both user-friendly and designed for maximum maneuverability in even the tightest spaces, we ask that you please read, understand and follow all of the instructions and suggestions in this manual before you operate your scooter for the first time. The safe use of your new scooter is very important to us.

If you feel that you do not understand the instructions and suggestions presented in this owner's manual, or if, for any reason, you do not feel capable of performing the activities necessary to assemble, disassemble, operate, or maintain your Buzzaround Carry On , please contact your local Golden provider or call Golden Technical Support Services at (800) 624-6374.

Golden cannot be held responsible for personal injury or property damage resulting from the unsafe or the improper use of any of our personal mobility products. Also, Golden cannot be held responsible for personal injury or property damage resulting from attempts to follow instructions, suggestions, and guidelines presented in this owner's manual.

Our Research and Development Department, our Quality Control Department, and our Engineering Department have used the latest product specifications and the latest product design information to manufacture your Buzzaround Carry On . Golden reserves the right to implement changes into our product lines when those changes become desirable or necessary. If changes are implemented into our product line, there may be minor differences between the product you purchased and the illustrations and instructions in this owner's manual.

Please fill out and mail the enclosed warranty registration card. Registration is also available @ www.goldentech.com. We at Golden would appreciate hearing about the dependability of your Buzzaround Carry On and about the convenience of mobility it has provided for you. We would also appreciate hearing about the service you received from your local Golden provider or representative.

Golden Technologies
401 Bridge Street
Old Forge, PA 18518

Phone: (570) 451-7477
Fax: (570) 451-7494
Toll free: (800) 624-6374

For more information about our products and services or to send us your comments, please visit our website at www.goldentech.com

II. Safety

Safety Guidelines

The symbols below are used in the owner's manual and/or on the product to identify warnings and to notify you of important safety information. Make sure you read and understand them completely.



WARNING! Indicate(s) a hazardous situation which, if not avoided, could result in death or serious injury. This icon is represented as a black symbol on a yellow triangle with a black border.



MANDATORY! Failure to perform mandatory actions can cause personal injury and/or equipment damage. This icon is represented as a white symbol on a blue dot with a white border.



PROHIBITED! Indicate(s) an action(s) that should not be performed under any circumstance. Failure to adhere can cause personal injury and/or equipment damage. This icon is represented as a red circle and red slash.

Safety Symbols

The symbols below identify warnings, mandatory actions, and prohibited actions. They can be found in the owner's manual and/or on the product. Make sure you understand all safety labels before operating the product. Do not remove safety labels from the product.



Read and follow the owner's manual!



Use Only Lithium Batteries!



Pinch/ Crush Hazard



Indoor Use Only



Electrical Hazard!



Do not use personnel electronic devices!



Hot Surface



Explosive conditions exist!



Corrosive chemicals inside battery!



Avoid transmitters!



Do not place into trash!



Recycle

II. Safety

Your Golden Buzzaround Carry On is a battery-operated vehicle. Please exercise caution and consideration when you are operating it. Driving your Buzzaround Carry On carefully and thoughtfully will help ensure your personal safety and the safety of other people.



Read and follow the owner's manual before operating your unit.



Do not attempt to use your Buzzaround Carry On on an escalator. Always use an elevator.



Do not carry passengers on your unit.



Do not operate your Buzzaround Carry On, if it is not functioning properly.



Use caution when driving on soft or uneven surfaces such as grass, gravel and on decks where there is no railing.



Never drive on the roadway, except when you must cross the street.



Always cross streets at intersections and use the most direct route, making sure that your path is clear and that you are visible to motor traffic.



It is not recommended to drive your Buzzaround Carry On, up or down a step or curb that is higher than 1-1/2 inches.



Never back up or down a step or curb.



Never operate your Buzzaround Carry On, while you are under the influence of alcohol.



Do not operate or store your scooter where it will be exposed to rain, snow, mist and below-freezing temperatures.



Never sit on your scooter when it is in freewheel mode and on an incline or decline.



Never sit on your Buzzaround Carry On when it is being transported.



Do not connect or allow anyone except an authorized Golden Provider to connect any electrical or mechanical device to your scooter. Unauthorized accessories will void the warranty and may cause injury.



Always keep your feet firmly on the footplate surface when operating your Buzzaround Carry On to eliminate any potential of your feet becoming entangled in the wheels of the scooter.



This product contains chemicals known to the State of California to cause cancer and birth defects or other reproductive harm.



Use caution when operating your Buzzaround Carry On while wearing long baggie clothing or clothing with loose belts, which could become entangled in the wheels of the scooter.



Always fasten down your Buzzaround Carry On securely with an approved tie-down system while transporting your scooter.

II. Safety



Never tether a live animal to your device, doing so may cause harm to yourself and the animal.



Do not operate or store your Buzzaround Carry On where it will be exposed to rain, snow, mist, and below freezing temperatures.



Never transfer on or off of this scooter using the seat backrest, arms, and footrest for support during transfer. This could cause you to lose your balance and could result in personal injury.



Do not modify your scooter in any way that is not authorized by Golden.



Should you encounter a problem with the operation of your mobility device such as a mechanical or electrical problem **immediately stop using the product**. Remove the battery pack from the scooter then contact the provider from whom you purchased your mobility device for evaluation of the problem and repair if needed.



Do not disassemble the tire. If disassembly is required, have your authorized Golden provider perform any necessary maintenance or repair.



The Buzzaround Carry On weighs 65.5lbs. Please be aware of this when attempting to store or transport.



The Buzzaround Carry On HD weighs 77.5lbs. Please be aware of this when attempting to store or transport.



Never lift this device by any movable parts.



No smoking while operating.



Exercise caution when handling packaged product. Hazards of toppling and sharp corners are present on packaged product.



Some body components on this device can be considered protruding edges. Be aware of all protruding edges present.



If the battery of this device becomes submerged in liquid **immediately stop using the product** and replace the battery.



Be aware of build up of hair or any fibrous material in and on the wheels as it may affect the operation of this device.



Do not operate this device in environments of extreme heat or cold or if the device itself is extremely hot or cold.



Golden excludes liability for any damages or data loss regarding the charging device on a computer or other electronic device connected to the USB port.

II. Safety

ENTERING AND EXITING



Have your Golden representative determine if it is advisable for you to practice getting on and off your scooter and operating it in the presence of an attendant.

Entering

- Check to be certain that the power is turned OFF. See "Operation" section. This will prevent the possibility of accidentally activating the scooter and causing injury to you or to others.
- Check to be certain that your Buzzaround Carry On is not in the freewheel mode. See the "Operation" section.
- Return tiller to full upright position if necessary.
- Carefully place one foot on the approximate center of the deck and seat yourself comfortably and securely on the seat..
- Flip down the armrests.

Exiting

- Make certain that the power is turned off.
- Flip up the armrests.
- Carefully stand and step away from the unit.



Never transfer on or off of this scooter using the seat backrest, arms, and footrest for support during transfer. This could cause you to lose your balance and could result in personal injury.



When getting on or off your Buzzaround Carry On, keep your weight toward the middle of the deck. Putting most or all of your weight on the edge of the deck may cause an unstable condition.

MAXIMUM WEIGHT

Your Buzzaround Carry On has been rated to a maximum payload (passenger and anything else being carried on the scooter) of 300 pounds.

Your Buzzaround Carry On HD has been rated to a maximum payload (passenger and anything else being carried on the scooter) of 400 pounds.



Exceeding the maximum weight capacity will void your warranty and may result in injury to yourself and/or others.

MEDICATION



Always check with your physician to determine if any of the medications you are taking may affect your judgment and/or your ability to operate your Buzzaround Carry On .



Also check with your physician concerning your physical ability to operate a scooter.

II. Safety

DRIVING ON AN INCLINE

- Drive with caution when attempting to negotiate any incline, even handicap access ramps.
- Try to keep your Buzzaround Carry On moving when climbing an incline. If you do come to a stop, restart and accelerate slowly and carefully.



Always climb or descend a gradient by driving straight up or straight down the face of the slope.



Do not attempt to negotiate an incline that is covered with snow, ice, cut or wet grass, leaves, or any other potentially hazardous material.



Do not try to descend or climb a slope whose gradient is greater than the recommended maximum incline of 6 degrees.



If, while you are driving down a slope, your scooter starts to move faster than you feel is safe, release the throttle control lever and allow your Buzzaround Carry On to come to a stop. When you feel that you again have control of your scooter, push the throttle control lever forward and continue safely down the remainder of the slope.



Do not traverse or drive across the face of a gradient.



Do not back down an incline.



Buzzaround Carry On maximum recommended incline is 6°.

The rapid development of electronics, especially in the area of communications, has saturated our environment with electromagnetic (radio) waves that are emitted by television transmitters, cellular phones, citizen's band radios (CBs), amateur radios (HAM radios), wireless computer links, microwave transmitters, paging transmitters, etc. These electromagnetic (EM) waves are invisible and increase in strength the closer one gets to the source of transmission. When these energy waves act upon electrical devices and cause them to malfunction or to function in an erratic or uncontrolled manner, they are referred to as Electromagnetic Interference (EMI) or Radio Frequency Interference (RFI).

EMI/RFI AND YOUR Buzzaround Carry On

All electrically powered vehicles, including scooters are susceptible to EMI/RFI. This interference could result in abnormal or unintended movement of your Golden Buzzaround Carry On .



Unintended movement or brake release could cause an accident or injury.

The FDA has determined that each make and model of scooter can resist EMI/RFI to a certain level. The higher the level of immunity, the greater the degree of protection from EMI/RFI measured in volts per meter (V/m). The FDA has also determined that current technology is capable of providing 20 V/m of immunity to EMI/RFI, which would provide useful protection against common sources of interference. This product has been tested and has passed an immunity level of 20 V/m

EMI/RFI RECOMMENDATIONS



PROHIBITED! Do not turn on or use hand-held personal electronic communication devices such as cellular phones, walkie-talkies, or CB radios while your scooter is turned on.

- Be aware of any nearby transmitters (radio, television, microwave, etc.) on your intended route and avoid operation your of scooter close to any of those transmitters.
- Turn off the power if your Buzzaround Carry On is going to be in a stationary position for any length of time.
- Be aware that adding accessories or components or modifying your scooter may make it more susceptible to EMI/RFI.
- If unintended movement or brake release occurs, turn your scooter off as soon as it is safe to do so.
- Report all incidents of unintended movement or brake failure to your Golden representative or to Golden.



Turn off your scooter as soon as it is safely possible if unintended or uncontrollable motion occurs or if unintended brake release occurs.

FCC RULES PART 15

This device complies with Part 15 of the FCC Rules. Operation is subject to the following two conditions: (1) this device may not cause harmful interference, and (2) this device must accept any interference received, including interference that may cause undesired operation.



Any changes or modifications to this unit not expressly approved by the party responsible for compliance could void the user's authority to operate the equipment.

NOTE: This equipment has been tested and found to comply with the limits for a Class B digital device, pursuant to Part 15 of the FCC Rules. These limits are designed to provide reasonable protection against harmful interference in a residential installation. This equipment generates, uses, and can radiate radio frequency energy and, if not installed and used in accordance with the instructions, may cause harmful interference to radio communications. However, there is no guarantee that interference will not occur in a particular installation. If this equipment does cause harmful interference to radio or television reception, which can be determined by turning the equipment off and on, the users encouraged to try to correct the interference by one or more of the following measures: (1) Reorient or relocate the receiving antenna. (2) Increase the separation between the equipment and receiver. (3) Connect the equipment into an outlet on a circuit different from that to which the receiver is connected. (4) Consult the dealer or an experienced radio/TV technician for help.

IV. Specifications



Model Number	GB120	GB220
Medicare Code	N/A	N/A
Weight Capacity	300 lbs.	400 lbs.
Drive	Rear	Rear
Maximum Speed	3.6 mph	4.29 mph
Operating Range	12.5 AH-14.4 miles 6.5 AH-7.5 miles Total-21.9 miles	12.5 AH-14.2 miles 6.5AH-7.4 miles Total-21.6 miles
Ground Clearance Under Deck	4"	4.63"
Ground Clearance to Transaxle/Motor	1.5"	2.3"
Turning Radius	48.75"	48.75"
Type Batteries (Lithium Ion)	12.5 AH & 6.5 AH	12.5 AH & 6.5 AH
Colors	Red, Blue	Red, Blue
Freewheel Mode	Yes	Yes
Electronic Speed Control	Yes	Yes
Electro-Mechanical Brakes	Yes	Yes
Charger	Off-board	Off-board
Controller	50 Amp	32 Amp
Length	38"	40"
Width	19.5"	23.5"
Height (ground to top seat back)	34.5"	39"
Ground to Top of Seat	23.5"	23.75"
Ground to Top of Deck	6"	6.625"
Deck to Top of Seat	17.5"	17.125"
Front Axle to Rear Axle	28.7"	28.7"
Weight of Unit: (assembled)	65.5 lbs.	77.5 lbs.
Main Body	47.5 lbs.	52.5 lbs.
Seat with Arms	12 lbs.	20 lbs.
Battery Pack	5 lbs.	5 lbs.
Maximum Height (folded without seat)	12"	12.63 "
Tires:	Solid, low profile	Solid, low profile
Front	6"	7.25"
Rear	7"	8.25"
Rear Anti-Tip Wheels	2"	2"
Standard Seat:	Stadium Style	Stadium Style
Seat Back Height	13.25"	15"
Width x Depth	17" x 14"	16" x 18"
Color	Black Vinyl	Black Vinyl
Warranty:		
Frame	Lifetime Warranty	Lifetime Warranty
Drive Train	2 Year Warranty	2 Year Warranty
Electronics	2 Year Warranty	2 Year Warranty
Batteries	2 Year Warranty	2 Year Warranty

*Specifications are subject to a tolerance variation of $\pm 2\%$. Battery range tested at 200 lbs. and will vary due to rider weight, drive surface, terrain and battery type.

V. Main Components



VI. Assembly

ASSEMBLY



Pinching and crushing hazard! Increased hazards due to pinching or crushing result due to the component weight (such as batteries) during preparation for transport and maintenance work. Always carry out any work to be done with great care. Always try to get help from a second person, especially when stowing parts for transport.



A pinch point is an area where you **MUST** consider your fingers to be sure they **DO NOT** become pinched between two metal or hard plastic areas. The greatest chance of pinch points becomes possible during the assembly of the Buz-around Carry On scooter.



Ensure that all components in the scooter have been correctly assembled. During assembly, please check that all connecting/locking devices are holding in place.

1. Squeeze the yellow tiller lever and raise the tiller up until it stops.

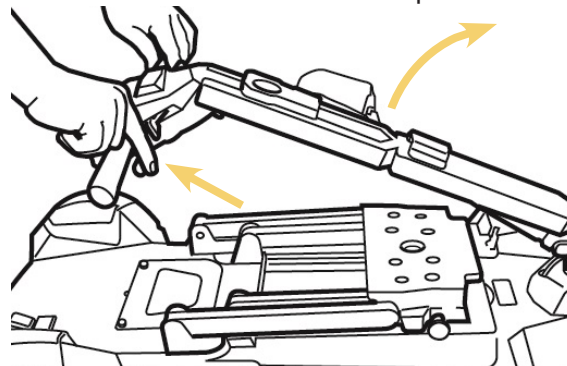

2. Grasp the seat pedestal as shown and pull the seat frame up and back until locked. An audible click can be heard indicating it is locked. Note: To lower the seat pedestal pull both spring loaded seat pins outward simultaneously, and while holding them out; push the seat frame forward and down.

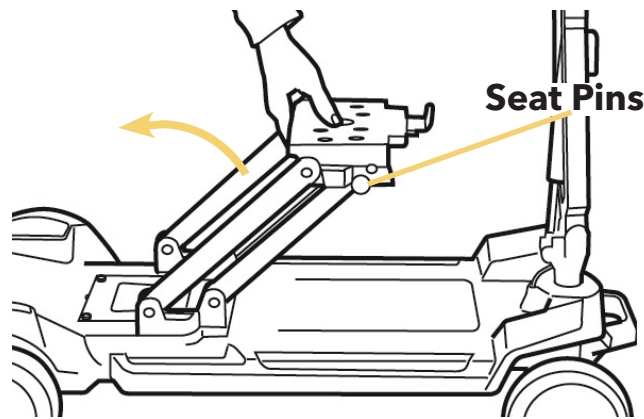

Accident hazard due to non-engaged seat Pedestal! Ensure that the seat is properly engaged.

VI. Assembly

ASSEMBLY

3. Remove the battery pack, by pushing in on the release button. Remove the controller cover under the seat pedestal. Install the fuse as shown. Reinstall controller cover and battery. Push down on the battery to lock it. An audible click can be heard indicating it is locked.

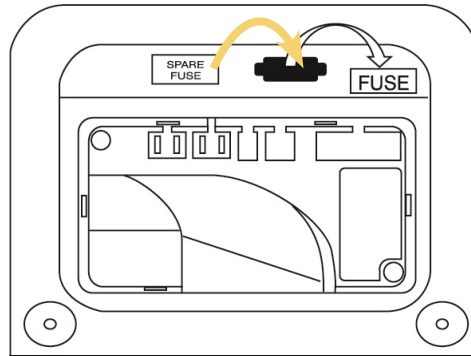
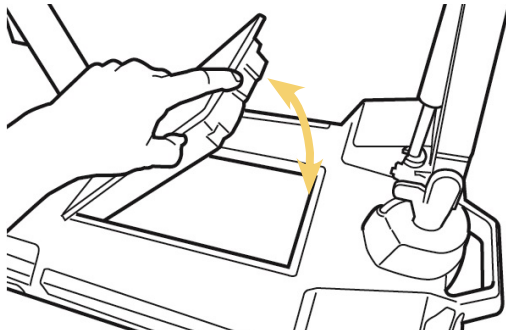

4. Place seat onto the seat frame facing forward and push down to lock it. An audible click can be heard indicating it is locked. Note: To remove the seat, lift upward while engaging the yellow release lever at the front of the seat.

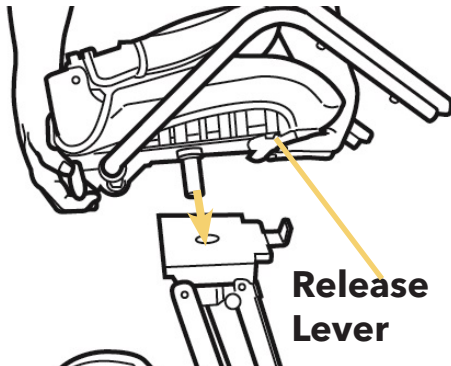

Accident hazard due to non-engaged seat! Ensure that the seat is properly engaged by turning the seat slightly left and right.

5. Complete the following steps to install the arms.

GB120

Pull each arm upward until they lock into place. An audible click can be heard indicating it is locked. Note: To lower the arm, pull outward and rotate down.

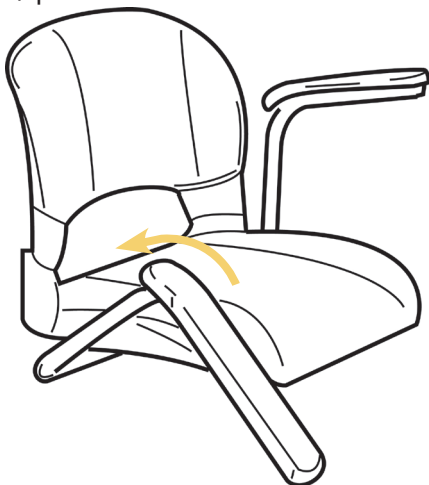

GB220

Line up the two teeth on the arm assembly with the cavity on the seat assembly as shown. Once the arm is fully inserted, rotate it into its downward position to lock it in.

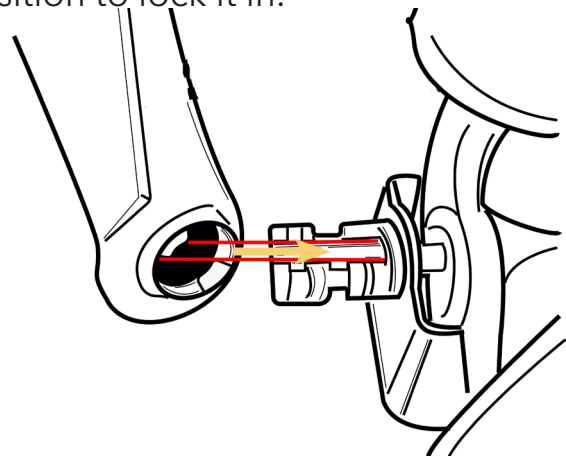

Assembly is now complete. Disassembly is the opposite of these steps.

VI. Assembly

WATER BOTTLE HOLDER & CANE HOLDER INSTALL

Your Buzzaround Carry On comes with a bottle holder and cane holder. Either or both can be used. Either accessory can be mounted on the right side or left side of the unit. Using the Allen wrench and hardware provided, mount and secure the accessories to the sides of the tiller as shown below.

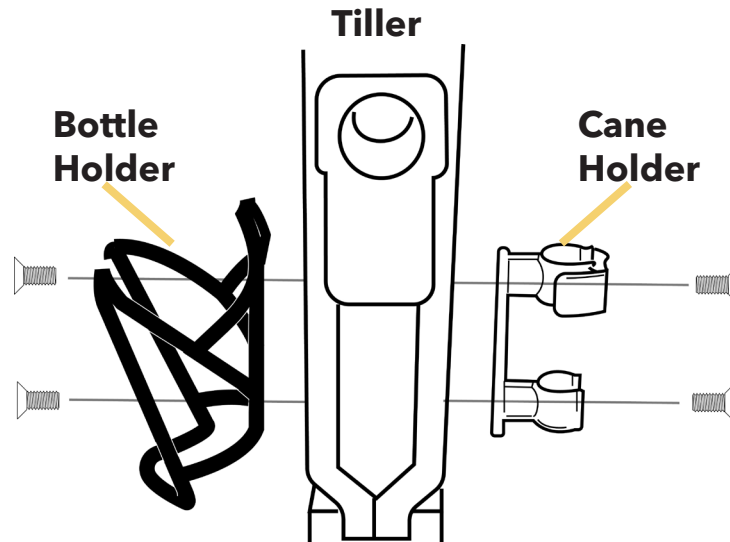

Be sure canes placed in the holder are properly mounted, secure, and do not obstruct the motion of the tiller in any direction. Failure to do so may cause harm.

TILLER LOCK

Your scooter is equipped with a hooks to lock the tiller in place when the unit is completely folded for easier transportation. Fold the tiller down, and hinge the two hooks forward to capture the handlebars. In the event your spare battery is in the rear holder, the elastic cords should be used.

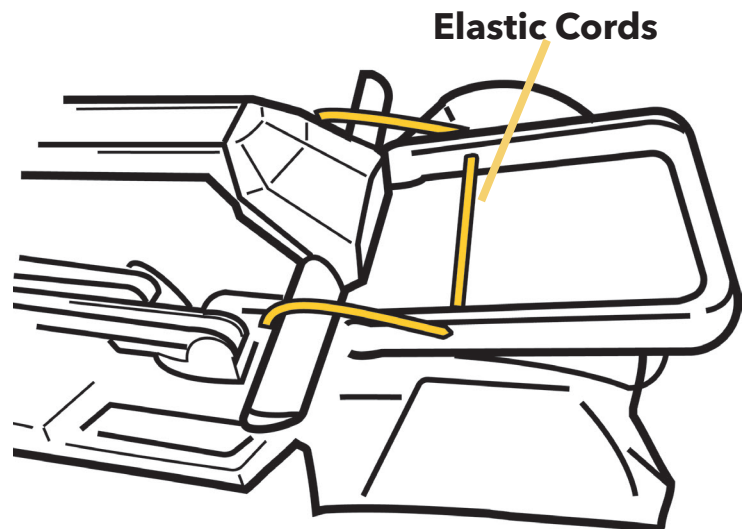
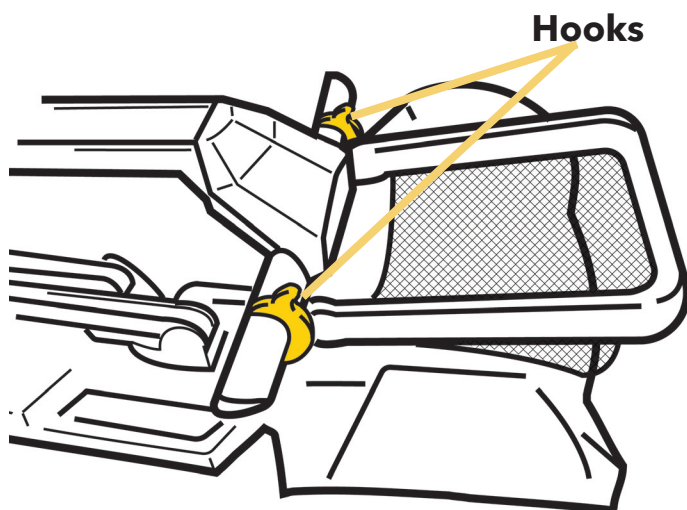

VII. Operation



Read and follow the owner's manual before operating your scooter.

Your Buzzaround Carry On is simple to operate. However, for your safety and the safety of others, Golden recommends that you carefully read and understand the following operating instructions. We also recommend that you practice operating your Buzzaround Carry On in an area free of any obstacles. Once you have gained confidence in your ability to control your scooter, you will more easily be able to operate it in normal daily conditions.



Before driving your Buzzaround Carry On, take note of your environment and set your speed control accordingly. For indoor driving, we recommend that you select the lowest speed setting. For outdoor driving, we recommend that you select a speed setting at which you feel comfortable, safe, and in control of your scooter. Familiarize yourself with the features of your Buzzaround Carry On described below and follow the instructions to safely operate your scooter.

DASHBOARD FEATURES

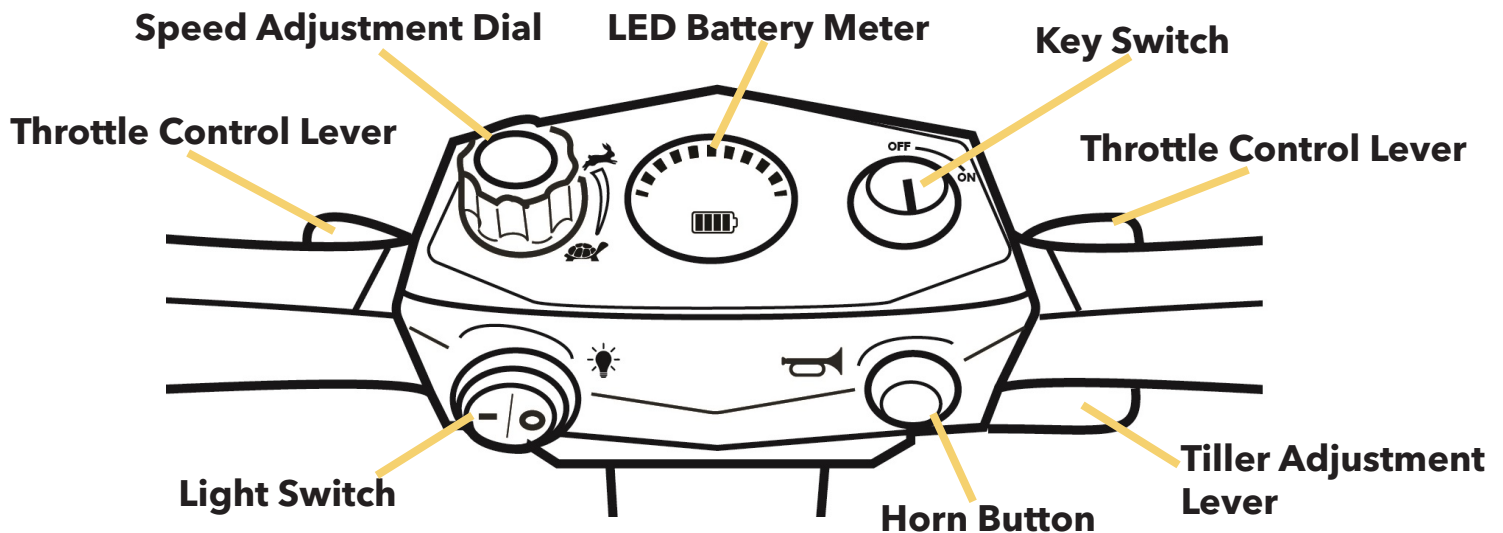

Speed Adjustment Dial

The speed adjustment dial allows you to preselect the maximum top speed of your Golden Buzzaround Carry On. Turn the dial clockwise to operate your scooter at the lowest speed level. Turn the dial counterclockwise to increase the operational speed of your scooter. We recommend that you select a speed setting at which you feel comfortable, safe, and in control of your Buzzaround Carry On.

Key Switch

This switch turns the power on and off to your Buzzaround Carry On. Insert the key into the key switch. Turn the key 90 degrees clockwise to turn on your scooter's power. The LEDs on the battery meter will light up indicating that power is on. Turn the key back to the vertical position to turn off your scooter's power.



Always make certain that the key is removed from the key switch before getting on or off your Golden Buzzaround Carry On or before lowering the tiller completely.

VII. Operation

DASHBOARD FEATURES

Light Switch

Allows you to activate and deactivate the lights on your scooter.

Horn Button

Press this button to sound the horn.

Throttle Control Lever

The Tiller enables you to use only one hand (either the right or left) to operate both the speed and the direction of the Buzzaround Carry On. This self-centering lever system controls your Buzzaround Carry On's speed (up to the maximum speed set by the speed adjustment dial and its forward and reverse direction.

Tiller Adjustment Lever

Allows you to adjust the angle of the tiller to a comfortable driving position. Engage the lever, move the tiller to your desired position, and release the lever to lock the position.

FREEWHEEL MODE

Your Buzzaround Carry On is equipped with a freewheel switch that can set your scooter in or out of freewheel mode. Freewheel mode will allow you to push the scooter manual if needed.

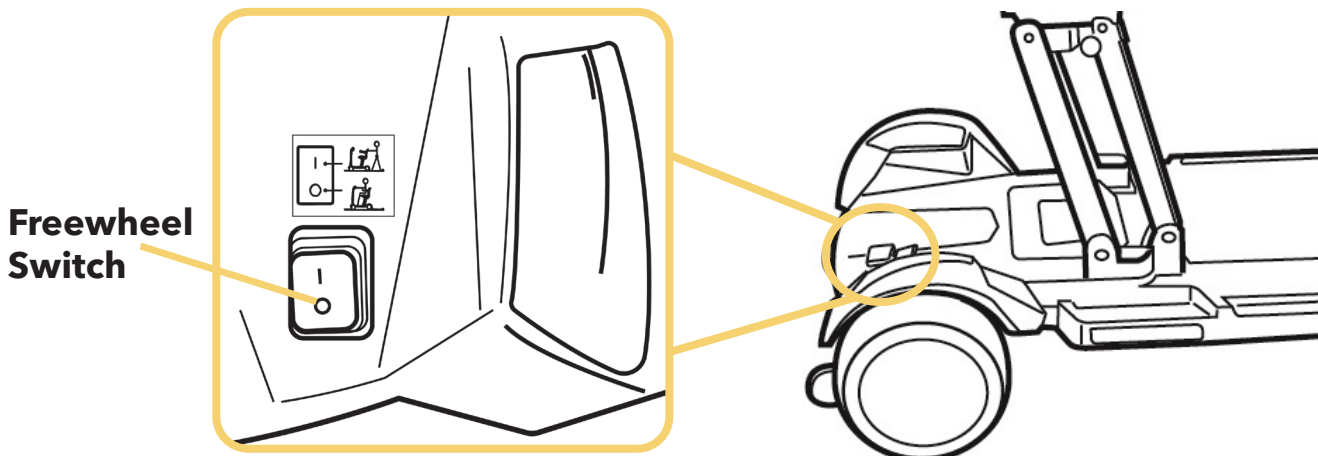

Pushing the scooter too quickly in freewheel will cause the motor to act as a generator causing the scooter to become difficult to push. Freewheel slowly.



Freewheel mode can only be used with the battery installed.



Never sit on your scooter when using freewheel mode. Never engage freewheel mode before or while operating your scooter.

VII. Operation



DRIVING

Basic Driving

- Refer to Entering and Exiting in the Safety section.
- Use the key to turn the scooter on.
- Make certain that you are seated safely and properly on your Golden Buzzaround Carry On.
- Turn the speed control dial fully clockwise to its slowest setting.
- Place your hands on the hand grips.
- If you wish to drive forward, pull back on the right side of the throttle control lever (or push the left side of the throttle control lever forward.)
- If you wish to drive in reverse, pull back the left side of the throttle control lever (or push the right side of the throttle control lever forward.)
- Pull on the throttle control lever to gently accelerate your Buzzaround Carry On.
- Release the throttle control lever to allow your Buzzaround Carry On to come gently to a full stop.
- Practice these two basic functions until you feel that you have control of your scooter.

Steering

- Steering your Golden Buzzaround Carry On is easy and logical.
- With both hands on the hand grips of the tiller, turn the tiller to the right to travel to the right.
- With both hands on the hand grips of the tiller, turn the tiller to the left to travel to the left.
- Make certain to maintain sufficient clearance when turning your scooter so that the rear wheels will clear any obstacle.



Turning your scooter too sharply at too high a speed may create a situation where one of the rear wheels will leave the ground. This may increase the possibility of tipping the scooter. Avoid this danger at all times by decelerating and steering a wide arc around corners and obstacles.



If you are unsure of yourself, start out on the lowest speed setting.



Exercise caution when operating in environments where loose gravel, wet grass, ice, and any other abnormal driving terrain is present.

Ending Your Driving Session

Be sure the unit is completely powered off and complete the opposite of these steps, also reference "Entering and Exiting" in the Safety section on page 7 for additional information.

HELPFUL DRIVING TIPS AND INSTRUCTIONS

Control Through Tight Spots

As you use your Buzzaround Carry On to increase your mobility, you will undoubtedly encounter some obstacles that will require practice to negotiate smoothly and safely. Below are some common obstacles that you may meet during the daily use of your scooter. Listed with those obstacles are some driving tips that should help you conquer those obstacles. Learn and follow those tips, and with surprising ease you will soon be in control of your scooter as you maneuver it through doors, up and down ramps, up and over curbs, through grass and gravel, and up and down inclines.

Doors

- Approach any unfamiliar door slowly.
- Notice if the door has a door knob or a push bar.
- Determine if the door opens towards you or away from you.
- Do not try to use your own strength to open the door. Learn to use the power of your scooter to do the majority of the work for you.

Ramps

Because of the American Disabilities Act (ADA), many buildings are fitted with ramps that provide access for power wheelchairs and for other mobility vehicles.



Please read and thoroughly understand “Safety” and “Driving On An Incline” sections of this manual.

VIII. Fault Diagnosis & Troubleshooting



Fault Codes

For your convenience, the Buzzaround Carry On has an automatic fault warning system. If, when powering up, there is a fault with the system, the battery meter will flash and the horn will beep. These faults are described in the table below.

GB120 & GB220

Fault code	Fault Diagnosis	Troubleshooting
1	Low Battery Voltage	Charge the batteries or batteries may require replacement.
2	Low Battery Voltage	Charge the batteries or batteries may require replacement.
3	Consult your authorized Golden provider.	
4	Motor Fault	Check electrical connections at frame connections. Be sure all connections and electrical items are properly mounted and secure.
5	Brake Fault	The scooter is in freewheel mode. Engage the freewheel lever and restart scooter.
6	Throttle Fault	Indicates a fault with the throttle lever. Restart the scooter and be sure the lever is not engaged.
7	Speed Adjustment Dial or Throttle Fault	Try restarting the scooter. May require parts replacement.
8	Motor Voltage Fault	Consult your authorized Golden provider.
9	Controller Fault	Consult your authorized Golden provider.

IX. Care & Maintenance

BATTERY CARE & CHARGING



New batteries must be fully charged prior to the initial use of your scooter.



Corrosive chemicals contained inside the battery. Explosive battery conditions exist.



Charger surface can become HOT. Electrical hazard!

Battery maintenance is the most important part of maintaining your scooter. Keeping the batteries fully charged helps to extend battery life. Use the following guidelines to help keep your batteries in optimum condition.

- For daily use, keep batteries fully charged. We recommend that you plug in the off-board charger after each use and charge 6-8 hours.
- If you are not going to use the scooter for more than a week, fully charge the batteries and then remove the battery pack from the scooter.

Charging Guidelines Checklist to Maximize Battery Life.

- Use only the automatic off-board charger supplied for all routine charging.
- Never use an automotive or wet type charger.
- Avoid deep discharges and never drain the batteries completely.
- Do not leave batteries in a low state of charge for extended periods. Charge a discharged battery as soon as possible.
- Fully recharge batteries regularly.
- Always store batteries fully charged.
- Check stored batteries once a month and recharge as necessary.

To Charge Batteries

The charger for all Buzzaround Carry On models is an off-board charger. To charge the batteries, plug the charger into the charger port on the battery pack or on the side of the console. See figures to the right. When the batteries are fully charged, disconnect the charger power cord from the wall outlet and from the charging socket. Note: Your scooter will not move while the charger remains connected.

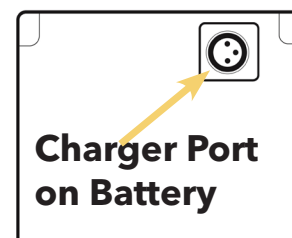
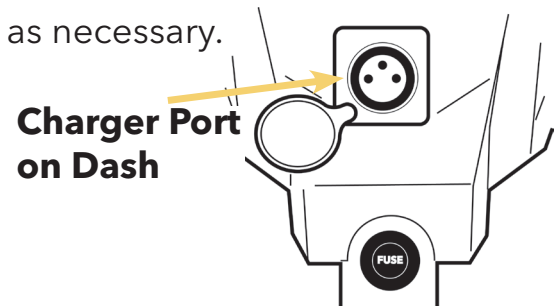

- Use only the Lithium Ion Battery included with the Golden Buzzaround Carry On scooters.
- These batteries are maintenance free.
- There is no danger of spillage or leakage, so these batteries are safely transportable on aircraft, buses, trains, etc.
- By following the procedures set out in this manual, you can expect extended life from our Golden Buzzaround Carry On's batteries.

IX. Care & Maintenance



ROUTINE MAINTENANCE

Your scooter requires a minimal amount of care and maintenance. If you do not feel confident in your ability to perform the maintenance listed below, you can schedule an inspection and maintenance with your retailer.

- Make sure your battery pack is fully charged daily. See "Battery Charging".
- While turned off, check the joystick control daily for damage, and make sure it returns to the neutral position. If any defects are observed, contact your retailer. Do not attempt to repair it yourself!
- Inspect the seating system, arms, and footplate daily for loose hardware, excessive wear, or damage. If any defects are observed, contact your retailer.
- Regularly inspect your scooter's tires for signs of wear.
- Regularly inspect all exposed harnessing and connections for wear, damage, and corrosion. Have your retailer repair or replace any damaged harnesses or connectors.
- Keep the electrical components (charger and joystick control) free from moisture. If these items do become exposed to moisture, let them dry thoroughly before attempting to operate your scooter again.
- Periodically check all fasteners for tightness, wear, and corrosion. If any of these are present, turn off the scooter and contact your retailer.
- All wheel bearings are permanently lubricated and sealed. No additional lubrication is required.



Be careful of pinch points and sharp metal parts (wear gloves).

We recommend that you check the following:

Tire Tread: Regularly visually inspect the tire tread. If the remaining tread is less than 1/32 of an inch, have your local Golden retailer replace the worn tires.

Dashboard: Protect the dashboard controls from adverse weather conditions. Moisture can damage the electronics and void your scooter's warranty.

Cleaning: Clean the body of your scooter with a damp cloth. Use a cool water mixed with a mild soap to remove dirt and oils. Dry with a clean soft cloth. Buff by hand with a soft cloth.



Do not use free-flowing water to clean your Buzzaround Carry On. Water and extreme temperatures are the main elements that can adversely affect your scooter and its performance.

IX. Care & Maintenance



Water, Rain, Sleet, and Snow

Water, in any form, will cause electronic malfunction or corrosion of the electrical components, connections, and the chair frame.

Temperature

Temperature can adversely affect the components and performance of your scooter.



At extremely low temperatures, the battery pack of your scooter may freeze, preventing your unit from operating. A frozen battery pack can not be safely charged. Do not operate the scooter if this condition exists, as it creates a safety hazard.



At extremely high temperatures, your scooter may operate at slower speeds due to the controller's thermal rollback feature that is designed to prevent damage to the motors and to the other electrical components of the scooter.

Storage

Your unit should be stored in a clean indoor environment with an ambient Temperature of 32°F -122°F, relative humidity $\leq 80\%$, with good ventilation.



Remove the battery pack from the scooter prior to storage.

TRANSPORTATION

Your scooter's compact attributes make it very friendly to transport.



Do not use the tires or wheels to lift the rear carriage. The carriage may rotate and cause injury or damage.



If your scooter and its components are not properly and securely stowed during transportation, they may move or become airborne and cause injury or damage.



Never sit on your scooter when it is being transported.



Fold Here First

Place
Stamp
Here

Golden Technologies
401 Bridge Street
Old Forge, PA 18518

Fold Here Second

 GOLDEN